

Madivalam, P.U.P. School Dining, Hand Wash Measurements								
Sl.No.	Name Of Materials	L	B	D	TOT	Qty	Tot Qty	Unit
I	DINING HALL							
1	Earthwork Excavation	2	2	1.5	6.000	6	36.00	CUM
2	Column							
	Footing PCC 1:4:8 M7.5	1.65	1.65	0.1	0.272	6	1.63	CUM
	Footing concrete RCC 1:1.5:3 M20	1.5	1.5	0.3	0.675	6	4.05	CUM
	Colom Concreate RCC 1:1.5:3	0.23	0.23	1.1	0.058	6	0.35	CUM
	Soil filling for colom	1.77	1.77	1.4	4.386	6	26.32	CUM
	Colom Piller RCC 1:1.5:3 M20	0.23	0.23	3.3	0.175	6	1.05	CUM
	REINFORCEMENT FOR FOOTING main bar 12 mm 200 spacing FOOTING SIZE 1.500 X 1.500 X 0.300 50 X D	1.89				120	201.60	kg
	REINFORCEMENT FOR COLUMN main bar 12mm 50xd used for vertical potion cover 0.035mm COLUMN SIZE 0.230 X 0.230	5.53				24	117.97	kg
	Rings using 8 mm dia bar spacing is 0.150	0.784				197	61.02	kg
	REINFORCEMENT FOR BEAM 12 mm using main bar incuded 3 laping also added 40xd used for horizondel potion BEAM SIZE 0.230 X 0.300	41.95				4	149.16	kg
	Rings using 8 mm dia bar spacing is 0.150 and also using 200 spacing using to c/c to mid potion using l by 4 metod using cover 0.035mm	0.924				212	77.39	kg
	binding wire per tone steel using bindig wire 7 to 13 kg					607.13	5.00	kg
3	Excavation Plinth beam	37.05	0.68	0.1	2.519	1	2.52	CUM
	PCC 1:4:8 M7.5	37.05	0.38	0.1	1.408	1	1.41	CUM
	RCC 1:1.5:3 M20	38.4	0.23	0.3	2.650	1	2.65	CUM
4	Solid Block work (400x200x200mm) 1:4	35.048	0.2	1.8	12.617	1	12.62	CUM
5	Plastering - Solod Block Pastering Inner 20 mm Tk 1:6	36.488		1.95	71.152	1	71.15	Sqmt
	Outer 20 mm Tk 1:6	37.348		2.1	78.431	1	78.43	Sqmt
	Column above structure level Plastering 20 mm Tk 1:6	5.52		1.5	8.280	1	8.28	Sqmt
6	Inner Structure							
	GRAVEL FILLING	11.52	7.235	0.4	33.339	1	33.34	CUM
	ATT Chemical using befoe flooring PCC	11.52	7.235		83.347	1	83.35	Sqmt
	Flooring PCC 1:4:8	11.52	7.235	0.1	8.335	1	8.33	CUM
	M- sand leveling	11.52	7.235	0.05	4.17	1	4.17	CUM
	Dining Seat for sold block work 2 side	0.4	0.2	0.45	0.036	50	1.80	CUM
	Dining Table for sold block work 2 side	0.6	0.2	0.75	0.090	30	2.70	CUM
	Plastering Dining Seat legs 20mm tk 1:6	1.2		0.45	0.540	50	27.00	Sqmt
	Plastering Dining Seat legs 20mm tk 1:6	1.6		0.75	1.200	30	36.00	Sqmt
	Cuddapha Slaps w-1'4" L-4' Thk-50 mm seat	0.4	1.2		0.48	30	14.40	Sqmt
	Cuddapha Slaps w-2' L-4' Thk-50 mm table	0.6	1.2		0.72	18	12.96	Sqmt
	Verify Tiles 600mmx600mmx8mm	11.72	7.435		87.138	1	87.14	Sqmt
7	Roof							
	MS steel Pipe 6" DIA = 4No.		0.075	3.3	0.2475	4	13.20	Rm
	Base and Top Plate	0.15	0.15		0.023	8	0.18	Sqmt
	Angering Bolte double side					32	32	Nos
	A Type Beam 3" x 1 1/2" horizodel	15.84			15.840	5	79.20	RM
	A Type Beam 1 1/2" x 1 1/2" vertical suport	8.2				5	41.00	RM
	Parlin Pipi 3" x 1 1/2"	12.43			12.430	10	124.30	RM
	GI Sheet	12.58	8.295		104.3511	1	104.3511	Sqmt
	Ridge	12.58	0.6		7.548	1	7.548	Sqmt
	SS Screw with waser					200	200	Nos
	Gutter Pipe	25.16				1	25.16	RM
8	WILD Mesh and side top closer	36.43		1	36.43	1	36.43	Sqmt
	MS Squire Tube Pipe 1 1/2" x 1 1/2" horizontal	36.43			34.43	3	103.29	RM

Sl.No.	Name Of Materials	L	B	D	TOT	Qty	Tot Qty	Unit
	MS Squire Tube Pipe 1 1/2" x 1 1/2" vertical support	1.5		1	1.5	38	57	RM
	GI Sheet side top closer	36.43		0.6	21.858	1	21.858	Sqmt
	SS Screw with waser					100	100	Nos
9	Door Details 2 Nos Steel Door	1		2.13	2.13	2	4.26	Sqmt
10	Outer side platform PCC 1:4:8	43.35	1	0.1	4.335	1	4.335	CUM
11	Steps	1.2	0.6	0.15	0.72	2	1.44	CUM
	Plastering	1.2	0.3		0.36	2	0.72	
12	Rain water harwesting							
	Earthwork Excavation	0.6	0.6	0.6	0.216	1	0.22	cum
	Rings	0.6	0.6	0.6	0.216	1	0.22	cum
	Sand	0.3	0.3	0.3	0.027	1	0.03	CUM
	Jelly 40mm	0.3	0.3	0.3	0.027	1	0.03	CUM
	Pipe	25.16			25.16	1	25.16	RM
13	Painting							
	1 cote white wash 2 cote Emulsion Inner and Outer	As per Plastering area overall sqmt			221.58	1	221.58	sqmt
	Enamel Paint Door 2 side	As per Door Details			8.52	2	17.04	sqmt
13	Electrical work						LS	LS
HAND WASH								
1	Hand washing Solid block work	0.45	0.2	0.4	0.036	4	0.144	CUM
	RCC 1:1.5:3 M20 CONCRETE	3	0.45	0.15	0.2025	1	1.17	Sqmt
	REINFORCEMENT FOT 8 MM MAIN BAR SPACING 0.150	2.93				3	3.472593	KG
	REINFORCEMENT FOT 8 MM DISTRUBUTER BAR SPACING 0.150	0.66				19	4.954074	KG
	Brick work	3.7	0.1	0.3	0.111	1	1.443	CUM
	Plastering Solid block	1.1		0.4	0.44	4	1.76	sqmt
	brick work inner	3.7		0.3	1.11	1	1.11	sqmt
	brick work Outer	3.9		0.45	1.755	1	1.755	Sqmt
	Tiles 600mm x 600 mm	4.25		1.2	5.1	1	5.1	Sqmt
	Hand wash Platform PCC 1:4:8	3	0.4	0.1	0.12		0.12	CUM
	Plastering Platform	6.8	0.4		2.72		2.72	Sqmt
	Plumbing work					LS		LS
1	Miscellaneous					LS		LS

Madivalam P.U.P School for Estimate Sheet Dining Hall and Handwash					
S.NO	Description Of Work	Qty	Unit	Rate	Total Amount
	Dining Hall				
1	Earthwork Excavation	36.000	CUM		
2	Column				
	PCC 1:4:8 M7.5	1.630	CUM		
	RCC 1:1.5:3 Footing Concreate	4.050	CUM		
	RCC 1:1.5:3 for column Concreate	1.400	CUM		
	Soil filling for column for 4 Mazdoor	26.320	CUM		
3	Plinth beam				
	Excavation	2.520	CUM		
	PCC 1:4:8 M7.5	1.410	CUM		
	RCC 1:1.5:3 M20	2.650	CUM		
4	SUPER Structure				
	Solid Block work (400x150x200mm) 1:4	12.620	CUM		
	Plastering - Solod Block Pastering Inner, Outer & column above level 20 mm Tk 1:6	157.860	Sqmt		
5	Inner Structure				
	Gravel Filling inner	33.340	CUM		
	ATT Chemical using befoe flooring PCC	83.350	Sqmt		
	PCC 1:4:8	8.330	CUM		
	M- sand leveling	4.170	CUM		
	Dining Seat & Table for sold block work 2 side	4.500	CUM		
	Plastering Dining Seat & legs 20mm tk 1:6	63.000	Sqmt		
	Cuddapha Slaps w-2' L-4' Thk-50 mm	27.360	Sqmt		
	Verify Tiles 600mmx600mmx8mm	87.140	Sqmt		
6	Roof				
	MS Pipe 6" dia	13.200	mts		
	Base and Top Plate	0.180	Sqmt		
	Angering Bolte double side	24.000	Nos		
	A Type Beam 3"x 1 $\frac{1}{2}$ "	47.520	RM		
	Parlin Pipi 3" x 1 $\frac{1}{2}$ "	124.300	RM		
	A Type Beam 1 $\frac{1}{2}$ " 1 $\frac{1}{2}$ " vertical suport	24.600	RM		
	GI Sheet 24 gauge	104.351	Sqmt		
	Ridge	7.548	Sqmt		
	Gutter Pipe 3" (25.160 RM)	LS	RM		
7	Welded Mesh and side top closer				
	Welded Mesh and side top closer	36.430	Sqmt		
	MS Squire Tube Pipe 1 1/2" x 1 1/2" horizontal vertical support	160.290	RM		
	GI Sheet longer & shorter side top closer	21.858	Sqmt		
8	Door Details 2 Nos	4.260	Sqmt		
9	Outer side platform PCC 1:4:8	4.335	CUM		
10	Steps	1.400	CUM		
	Plasterings	0.720	Sqmt		
11	Painting - 1 cote white wash 2 cote Emulsion Inner & Outer	221.580	Sqmt		

S.NO	Description Of Work	Qty	Unit	Rate	Total Amount
	Enamel Paint Door 2	17.040	Sqmt		
12	Electrical 3 Tube light with switch-3 wiring item	LS	LS		
13	Rain water harwesting	LS	LS		
Total A					
II	Hand Wash				
1	Hand washing Solid block work	0.144	CUM		
	Hand wash Platform PCC 1:4:8	0.120	CUM		
	RCC 1:1.5:3 M20 Shtring	1.170	Sqmt		
	Brick work	1.433	cum		
	Plasterings	7.435	sqmt		
	Tiles 600mm x 600 mm	5.100	Sqmt		
2	Plumbing work	LS	LS		
1	Miscellaneous	3000.00	LS		
Total B					
Total A+B					

MADIVALAM DINING HALL

No: 35

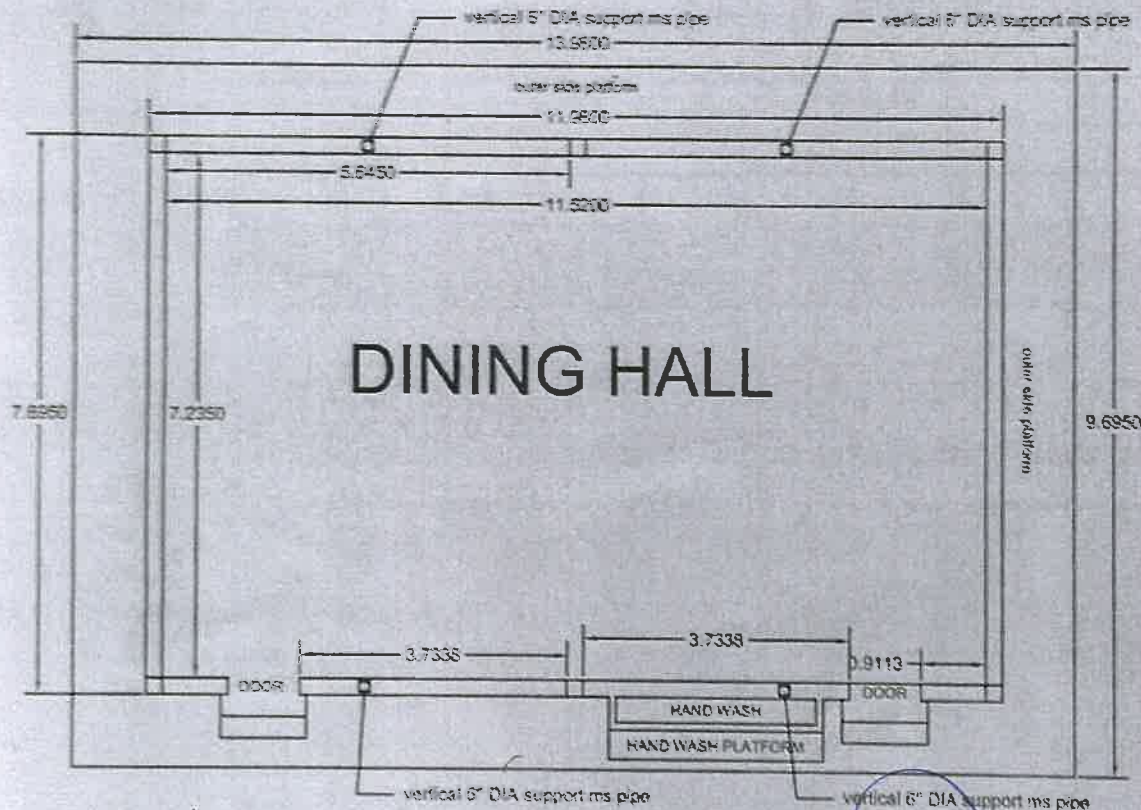

NOTE

ALL DIMENTION ARE IN METAR
 DOOR SIZE = L = 1.000 H = 2.19 using steel door
 NO OF DOOR = 2 NOS
 COLUM SIZE = L - 0.230 * B - 0.230
 COLUMN NOS = 6 NOS
 STEPS SIZE = L - 1.2 * B - 0.3 * H - 0.15 = 2 NOS
 NO OF STEP = 2 NOS
 HAND WASH PLAT FORM SIZE = L - 3.000 * B - 0.400
 HAND WASH SIZE = L - 3.000 * B - 0.450
 WALL THICKNESS = 0.230

DINING HALL DOOR DETAILS MADIVALAM			
SL NO	DESCRIPTION	SIZE	NO OF COLUMN
1	Steel Door	3 x 7	2

[Signature]
 Civil Engineer,
 Samagra Shiksha, 02/11/23
 State Project Directorate,
 DPI Campus, Nungambakkam,
 Chennai - 600 006.

[Signature]
 State Civil Consultant,
 Samagra Shiksha,
 State Project Directorate,
 DPI Campus, Nungambakkam,
 Chennai - 600 006.

For DEEPAM RURAL DEVELOPMENT,
 CHARITABLE TRUST
[Signature]
 Project Engineer

MADIVALAM DINING HALL

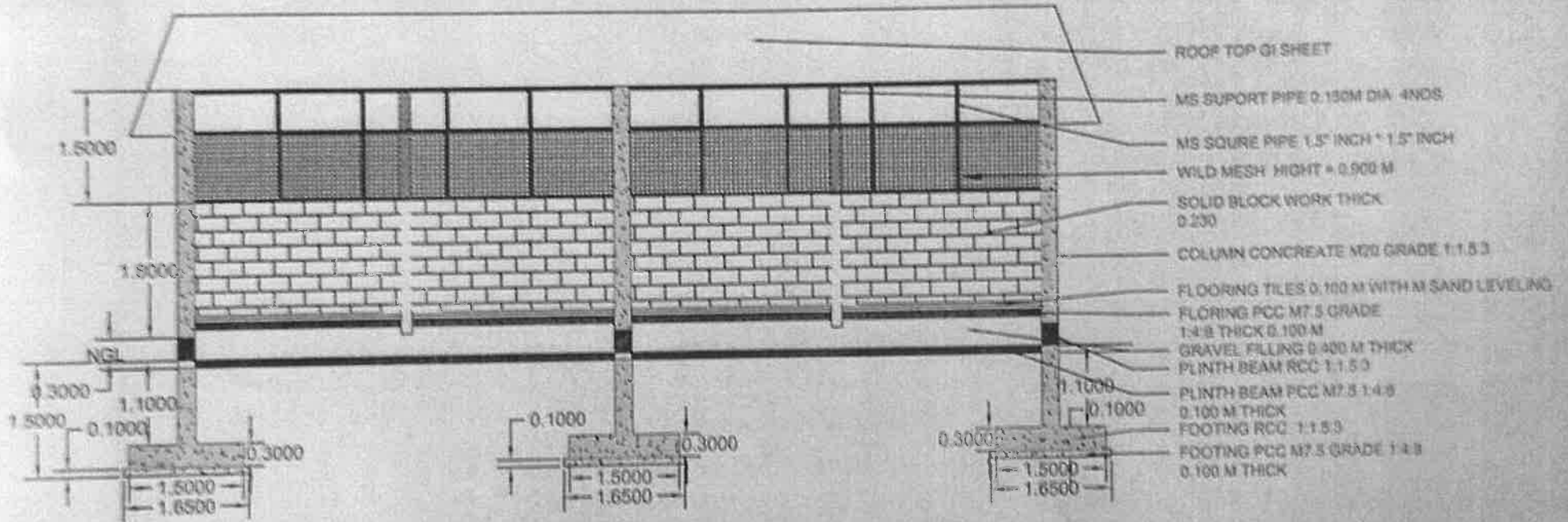

For DEEPAM RURAL DEVELOPMENT
CHARITABLE TRUST

Red
Project Engineer

FOOTING CENTER LINE DRAWINGS

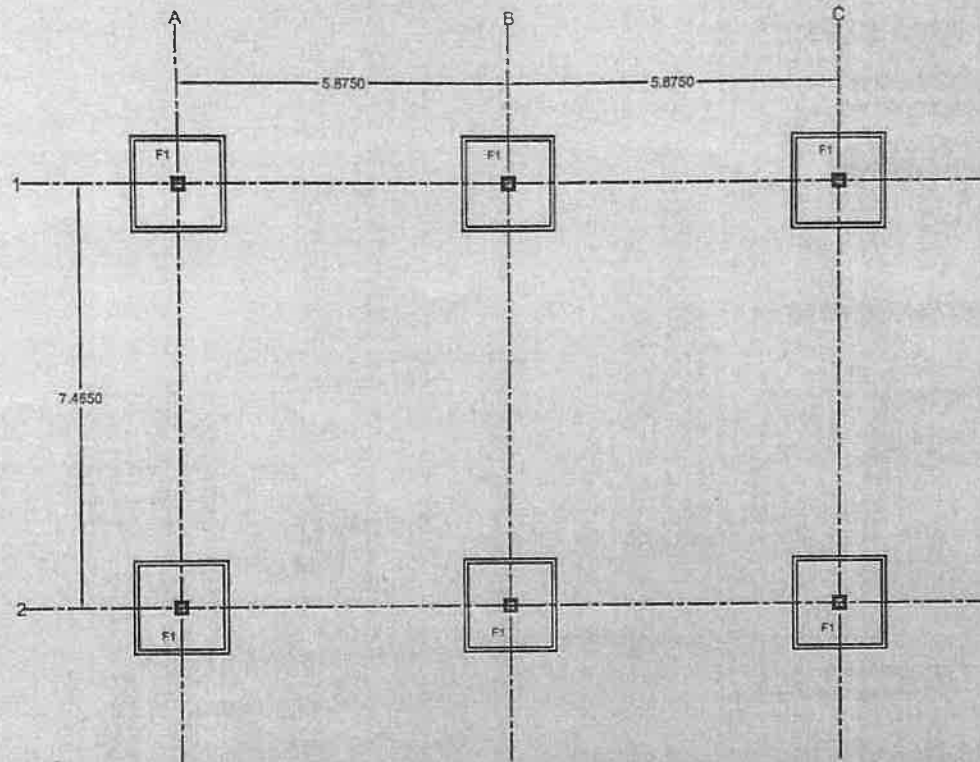

DINING HALL FOOTING DETAILS					
SL NO	FOOTING NO	FOOTING SIZE	TOP REINFORCEMENT	BOTTOM REINFORCEMENT	NO OF FOOTING
1	F1	1.5 X 1.5 X 0.3	Y12 @ 200 c/c	2- Y12	6

DINING HALL COLUMN DETAILS					
SL NO	COLUMN NO	COLUMN SIZE	MAIN BAR	STIRUPS REINFORCEMENT	NO OF COLUMN
1	C1	0.230 X 0.230	4 - Y12	Y8 @ 150 C/ C	6

For DEEPAM RURAL DEVELOPMENT
CHARITABLE TRUST

R. K.
Project Engineer

FOOTING DETAILS

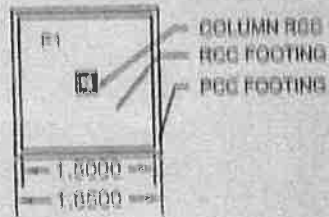

PLAN

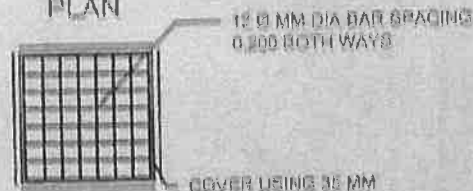

SECTION 1.2 FOOTING MAT

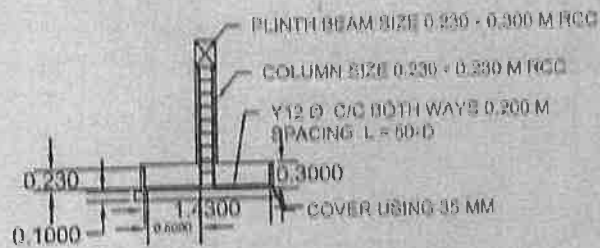

SECTION 1.1

COLUMN DETAILS

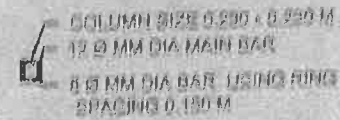

PLINTH BEAM DETAILS

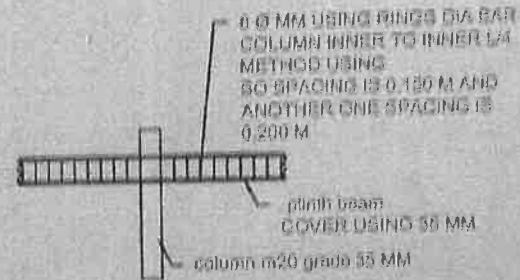
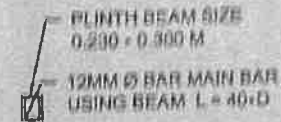

PLINTH BEAM SECTION 1.1

For DEEPAM RURAL DEVELOPMENT
CHARITABLE TRUST

[Signature]
Project Engineer

PLINTH BEAM CENTER LINE DRAWING

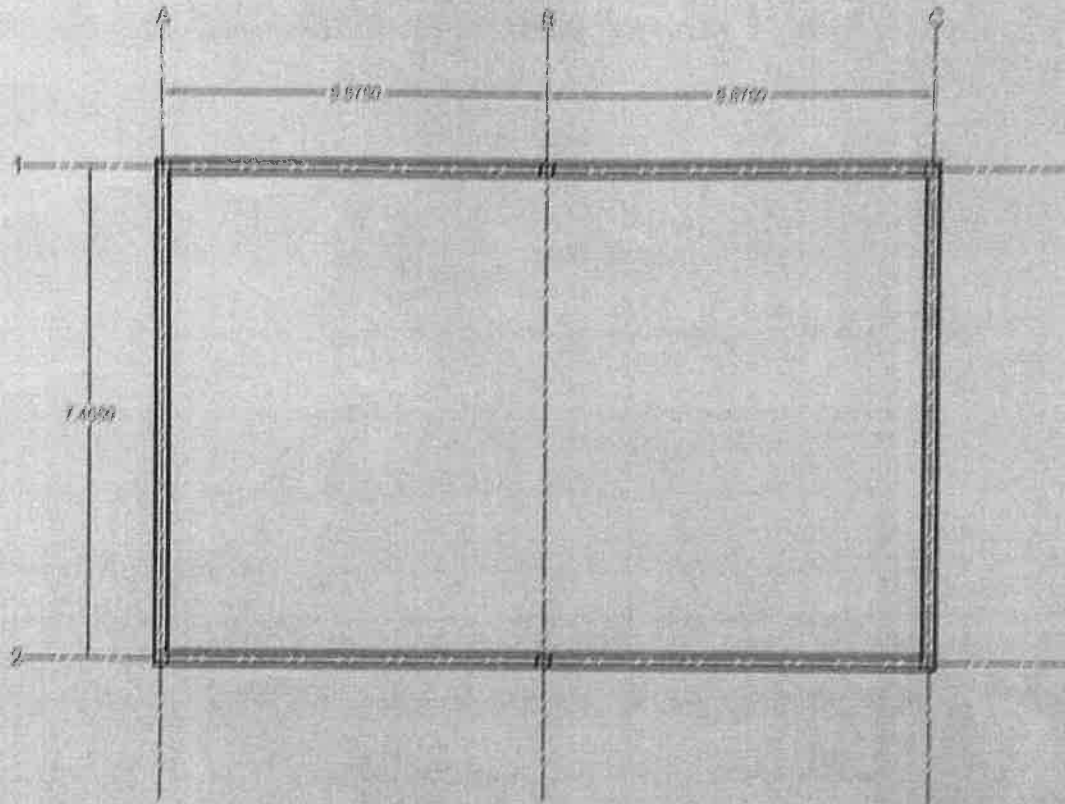

(X)TING WALL SCHEDULE FOR PLINTH BEAM REINFORCEMENT DETAILS

SL. NO.	BEAM NO.	BEAM SIZE	TOP	BOTTOM	STIRUPS		NO OF BEAM
			REINFORCING MT	REINFORCING QTY	REINFORCEMENT DETAILS		
1	101	0.230 X 0.300	2-Y12	2-Y12	10- ϕ 10 @ 100	10- ϕ 10 @ 100	1

FOR DEEPAW RURAL DEVELOPMENT
CHARITABLE TRUST

[Signature]
Project Engineer

ROOF PLAN FABRICATION FOR USING GI SHEET

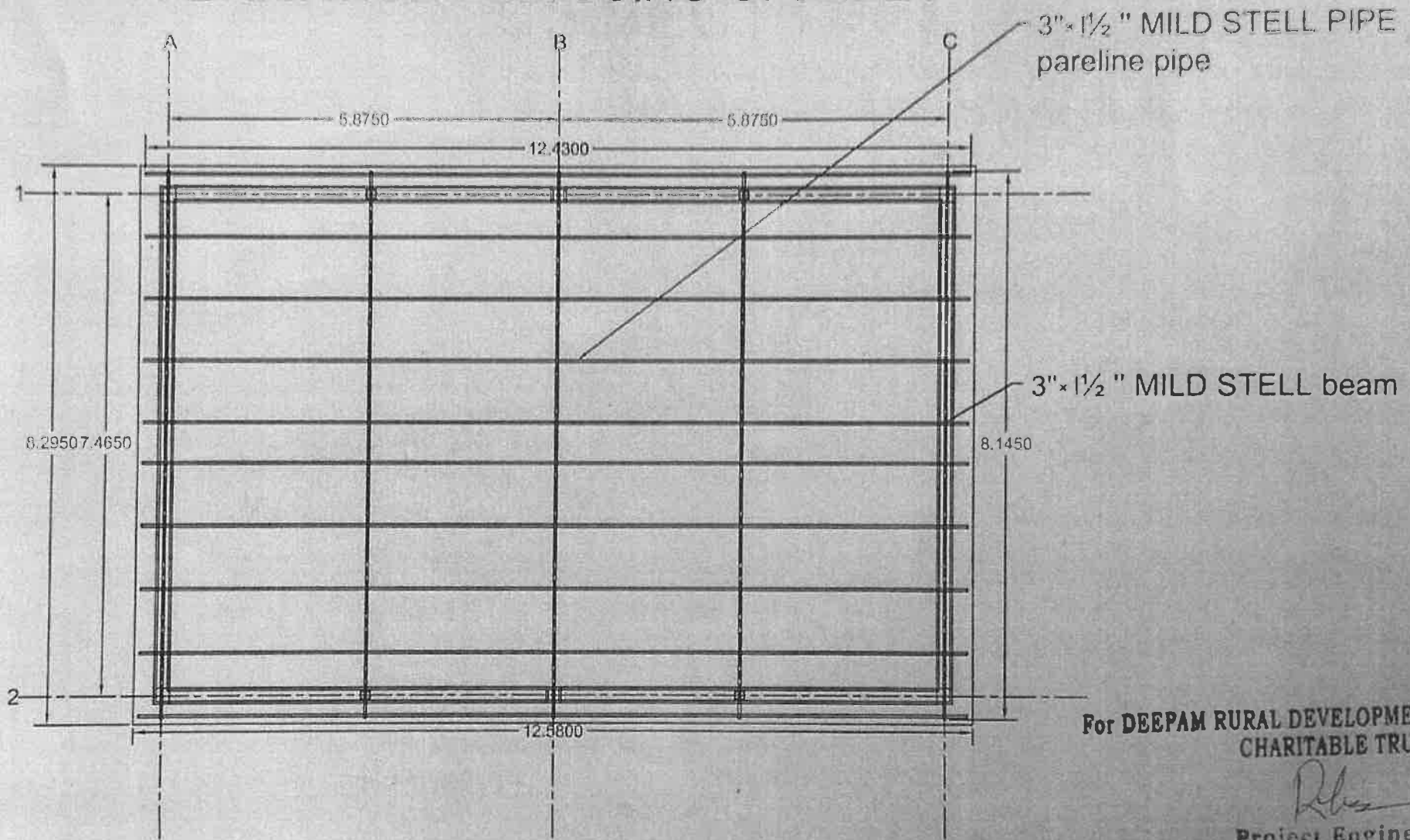

A TYPE TRUSS SECTION 1

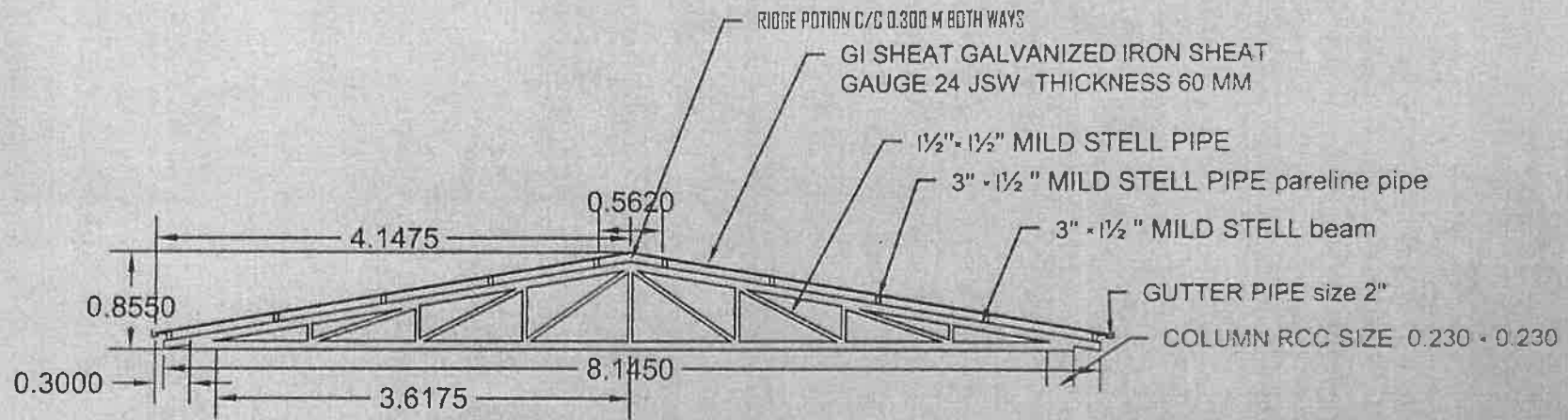

DINING HALL ROOF DETAILS CHINAE LASKIRI			
SL NO	DESCRIPTION	SIZE OF USING STEEL PIPE	NO OF COLUMN
1	A TYBE BEAM	3" - 1.5" STEEL PIPE	5
2	SUPORT PIPE VERTICAL	6"	4
3	PARLIN PIPE	3" - 1.5"	--
4	GI SHEET	1 mtr	1
5	GUTER PIPE	3"	1

For DEEPAM RURAL DEVELOPMENTS,
CHARITABLE TRUST

Signature